

### Application

Brio's Zero Clearance Glass is an ideal internal system for residential and commercial applications for easy operation of toughened glass panels.

Designed to achieve minimal clearances of just 2.5mm between top edge of the glazing rail and underside of the track.

Zero Clearance Glass 100 hangers are equipped with precision bearings.

### Panel Specification

**Track System:**

For Individual Panels:  
 Max Panel Height  
 Max Panel Width  
 Max Panel Weight  
 Panel Thickness

**Zero Clearance Glass 100**

3000mm  
 1500mm  
 100kg  
 10-12mm

### Standard Packs

Packs include hangers, door stops, glazing rail, glazing bead, guide and handle

**Pack No.**

ZG100-12/1  
 ZG100-15/1

**Max Panel Width**

1200mm  
 1500mm

### Hardware Specification

**Track:**

Material  
 Standard lengths

100  
 Aluminium clear anodised  
 2000mm, 3000mm, 4000mm and 6000mm

**Accessories:**

Handle  
 Soft Close  
 Clip Stop

535G  
 100SCT  
 100CS

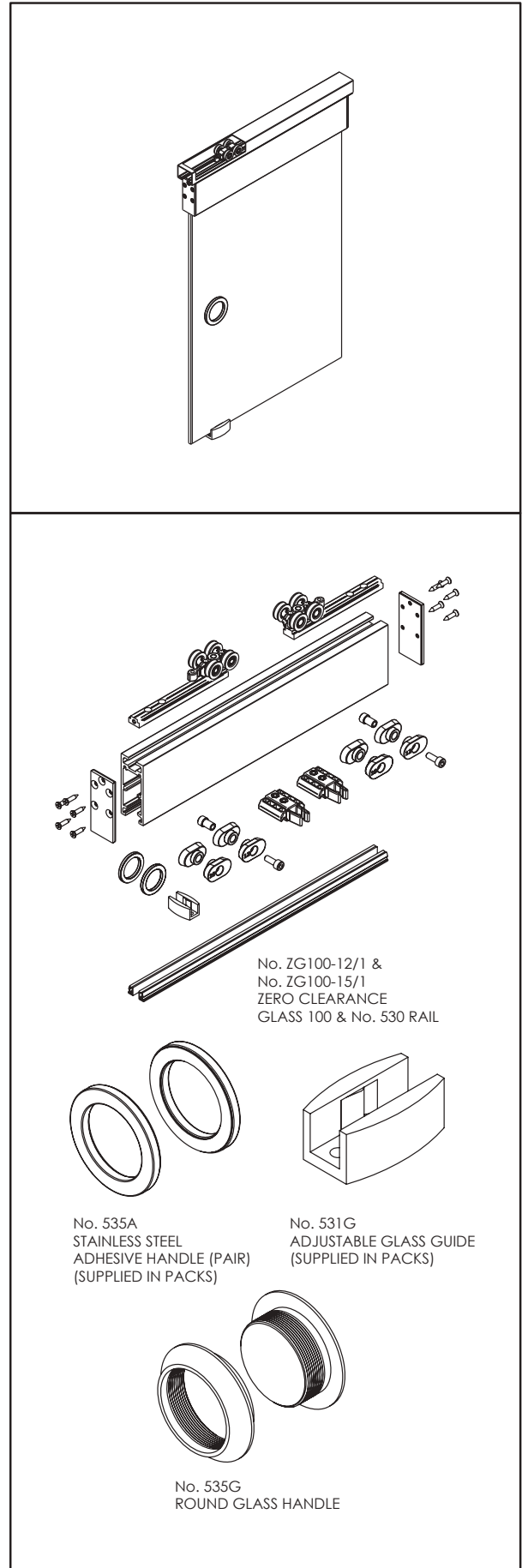

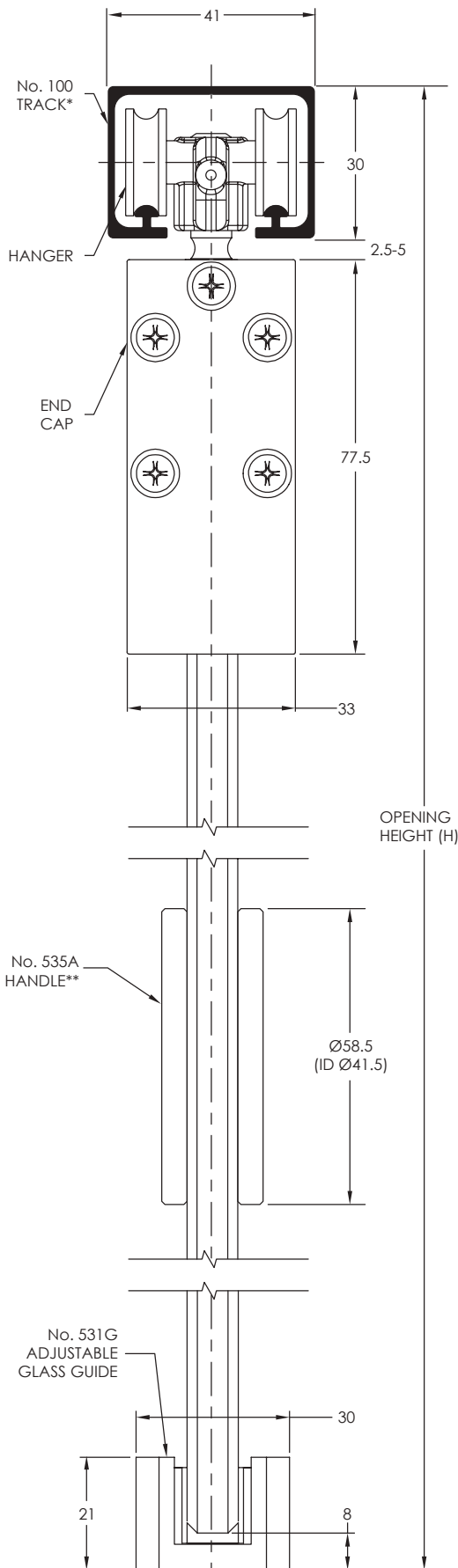

### TRACK FIXING CENTRES

35mm FROM EACH END, 400mm MAXIMUM

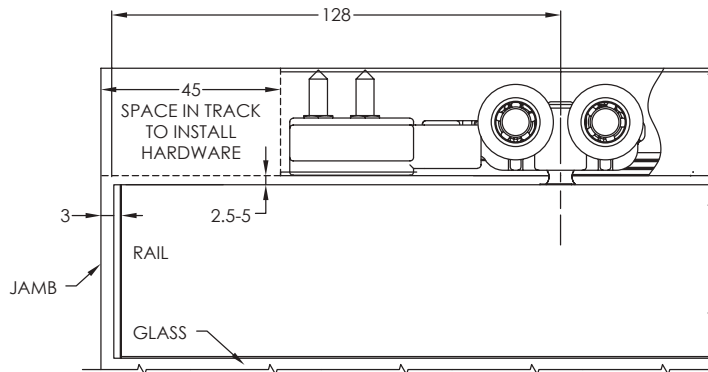

### GLASS PREPARATION FOR ALL HANGERS

CUT GLASS SIZE = OPENING HEIGHT (H) - 60mm  
 FOR PANELS ≤ 1000mm 2 FIXINGS REQUIRED  
 \*FOR PANELS ≥ 1001mm 3 FIXINGS REQUIRED

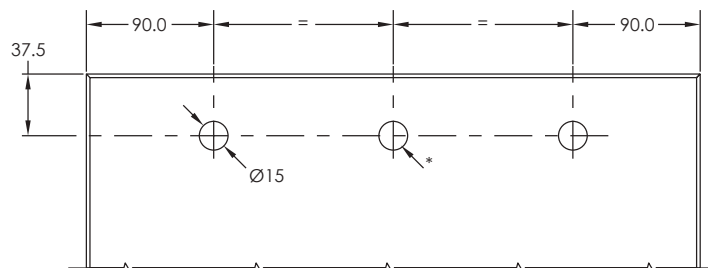

### INSTALLATION

1. CHOOSE FITTING FOR 10mm OR 12mm GLASS.
2. CLAMP INTO PRE-DRILLED HOLES USING 5mm ALLEN KEY
3. INSERT CLAMPS INTO RAIL

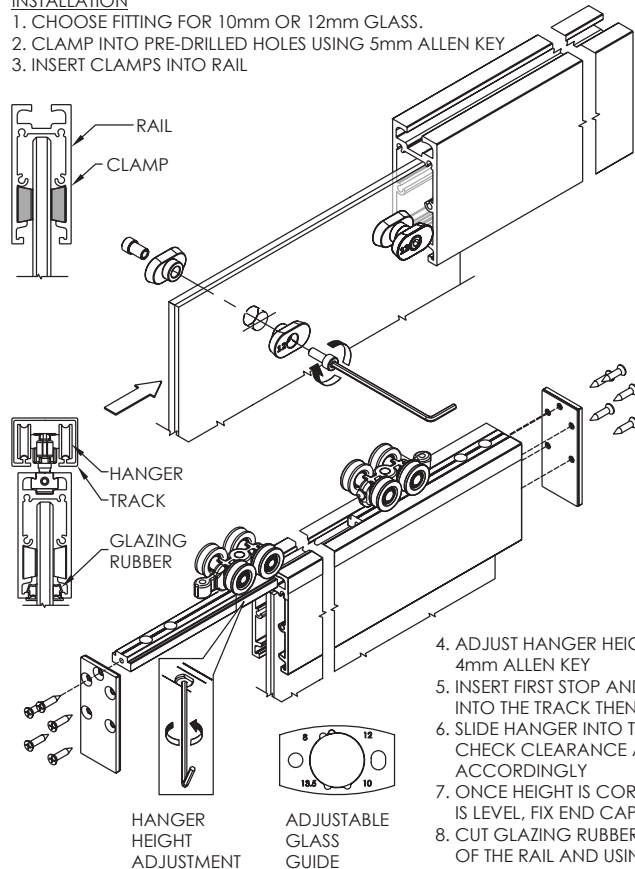

4. ADJUST HANGER HEIGHT USING 4mm ALLEN KEY
5. INSERT FIRST STOP AND HANGERS INTO THE TRACK THEN THE LAST STOP
6. SLIDE HANGER INTO THE RAIL. DOUBLE CHECK CLEARANCE AND ADJUST ACCORDINGLY
7. ONCE HEIGHT IS CORRECT AND PANEL IS LEVEL, FIX END CAPS ONTO THE RAIL
8. CUT GLAZING RUBBER TO THE LENGTH OF THE RAIL AND USING DETERGENT PUSH IN. APPLY BOTH SIDES
9. PREPARE GUIDE ACCORDING TO THICKNESS OF GLASS. FIX GUIDE TO OVERLAPPING AREA OF OPENING

\* WHEN USING No. 100SCT SOFT CLOSE, No. 100 TRACK MUST BE ANODISED  
 \*\* FOR No. 535G ROUND GLASS HANDLE, MACHINE A Ø50 HOLE TO FIT HANDLE